

Model 700C

Sanitary Diaphragm Seals for Sanitary Piping Systems

Instrument Connection Sizes

1/4" NPTF or 1/2" NPTF

Maximum Working Pressure

Determined by Piping System Clamp Rating

Dimensional Data

See drawings below.

Standard Features and Options

This clamped, off-line seal has a diaphragm welded to the upper housing. Designed to ensure that the surfaces exposed to the process are virtually crack and crevice free. The diaphragm and wetted materials are 316 Stainless Steel. The displacement capability of this seal is determined by the diaphragm diameter that the process pipe will accommodate. Due to the limited displacement capability of some of the sanitary pipe sizes, careful consideration should be used when choosing the appropriate size.

* Models indicated meet the requirement of the 3-A Sanitary Standard.

Offerings

Upper Material: 316 Stainless Steel

Diaphragm Material: 316L Stainless Steel (See Note 4)

Note: ITT Conoflow does not regularly supply associated pipe clamps and gaskets.

CONTROL ENGINEERING DATA

700C-1152N

(10) FILL LIQUID

N = Standard

(9) SEAL INSTRUMENT CONNECTION

2 = 1/4" NPTF (6.35mm) w/Bleed

4 = 1/2" NPTF (12.70mm) w/Bleed

(1-8) DIAPHRAGM SEAL DESIGN

SEAL TYPE	SIZE	PIPING SYSTEM DESIGNED TO FIT	CONNECTOR (SEE NOTES 1 AND 2)
*700C-115 =	1-1/2"	Ladish "Tri-Clamp"(3) Cherry Burrell "S" Line G & H GC Fast Clamp	Clamp
*700C-120 =	2"		
*700C-125 =	2-1/2"		
*700C-130 =	3"		
*700C-220 =	2"	CB "I" Line	Clamp
*700C-230 =	3"		
*700C-240 =	4"		
*700C-320 =	2"	Cherry Burrell "Q" Line	Clamp
*700C-420 =	2"	G & H GC "H" Line	Clamp
*700C-520 =	2"	APC "Quick Connect"	Clamp
*700A-628 =	2"	Anheuser Busch	814C-Nut
*700A-626 =	2"		614C-Nut
*700D-820 =	2"	Ashcroft Replacement	Ring
700CEX =	Welded in line systems. This seal is custom designed to fit almost any piping system and utilizes clamping and other connectors as specified by the customer.		

CATALOG NUMBERS AS RECEIVED FOR THE 700 SERIES MUST CONTAIN TEN (10) CHARACTERS

Notes:

1. Clamp nuts or rings and gaskets are not normally supplied by ITT Conoflow.
2. Maximum operating pressure of the system is determined by the clamping device. IMPORTANT - For higher pressure clamps (1000 PSIG (6.90 MPa) or higher), consult the factory for product specifications.
3. When ordering a diaphragm seal for a Tri-Clamp piping system utilizing a 13MHP (high-pressure) clamp, then add the suffix "7481" to the catalog number.
4. Standard wetted surface finish is 32R_a. For wetted surface finishes of 20R_a (electro-polished), add suffix "7605" to the catalog number.

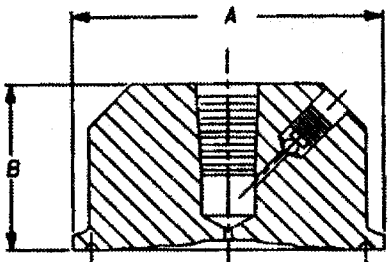

700C-100*

Model	115	120	130
Nominal pipe size	1.5	2	3
Diaphragm Diameter Inches	1.4	1.9	2.4
A	1.989	2.521	3.581
B	1.25	1.25	1.25

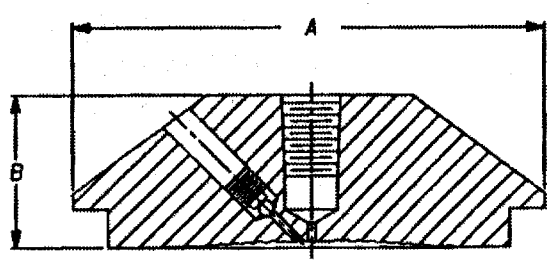

700C-200*

Model	220	230	240
Nominal pipe size	2	3	4
Diaphragm Diameter Inches	1.9	2.4	2.4
A	2.645	3.875	4.875
B	1	1.25	1.25

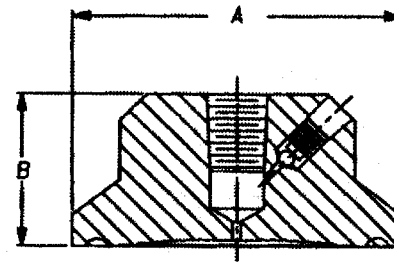

700C-300*

Model	320
Nominal pipe size	2
Diaphragm Diameter Inches	1.9
A	2.645
B	1.25

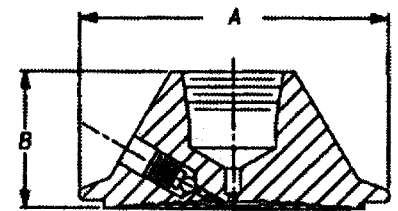

700C-400*

Model	420
Nominal pipe size	2
Diaphragm Diameter Inches	1.9
A	2.516
B	1.125

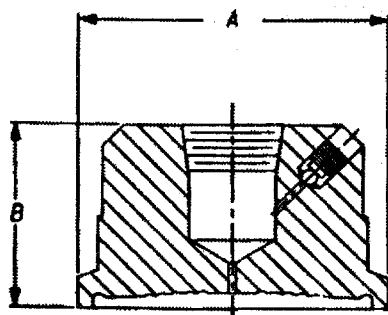

700C-500*

Model	520
Nominal pipe size	2
Diaphragm Diameter Inches	1.9
A	2.500
B	1.5

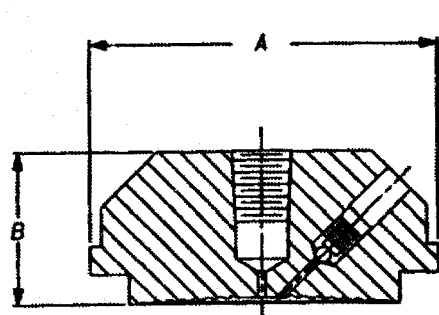

700A-600*

Model	628	626
Nominal pipe size	2-814C	2-614C
Diaphragm Diameter Inches	1.9	1.9
A	2.875	2.875
B	1.25	1.25

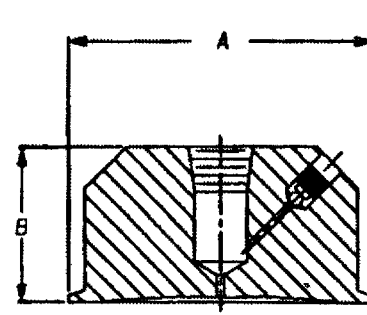

700D-800*

Model	820
Nominal pipe size	2
Diaphragm Diameter Inches	1.9
A	2.521
B	1.25

700CEX

Custom designed to fit almost any piping system and utilizing clamping or other connectors as required by customer.